

Non Load bearing GRP Floor as standard

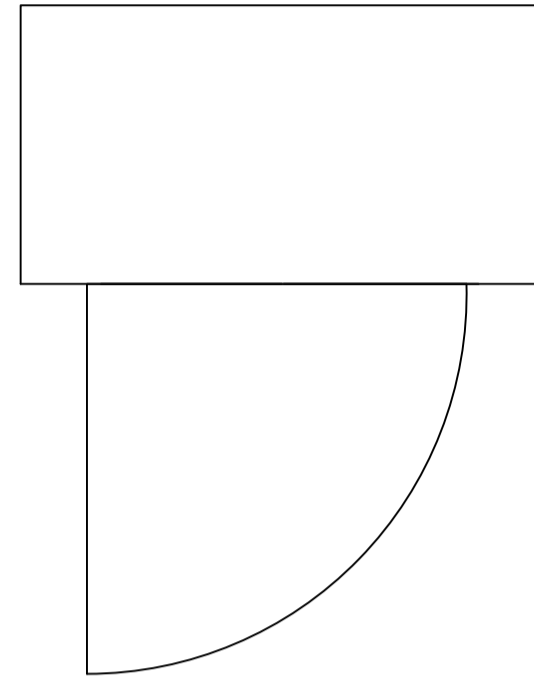

1No. 580 x 890 mm, 18mm Surface Treated Ply Backboard

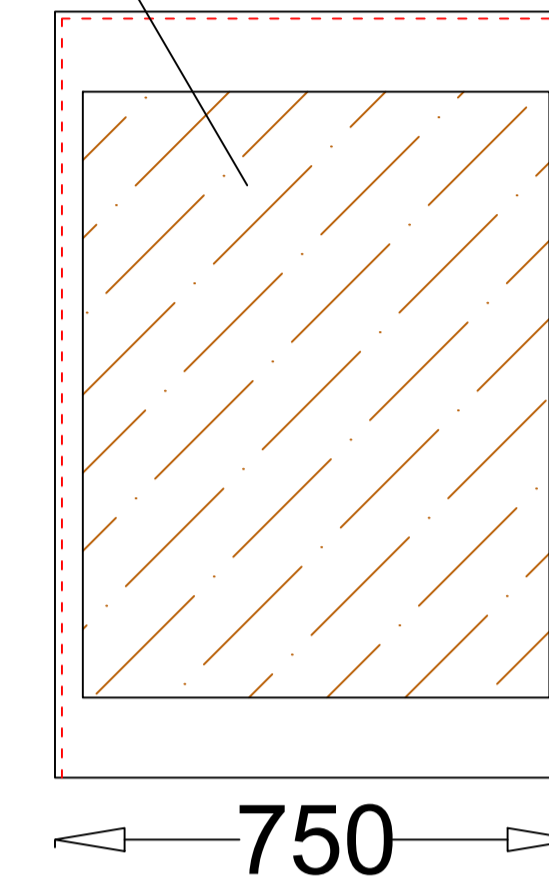

Clear Internal Dimensions - 740mm x 290mm x 1090mm

- 1No. Single door (560 mm W x 850mm H Clear Opening)
- 2No. St/St Hinges
- 1No. Yale type Lock
- 1No. Compression Seal

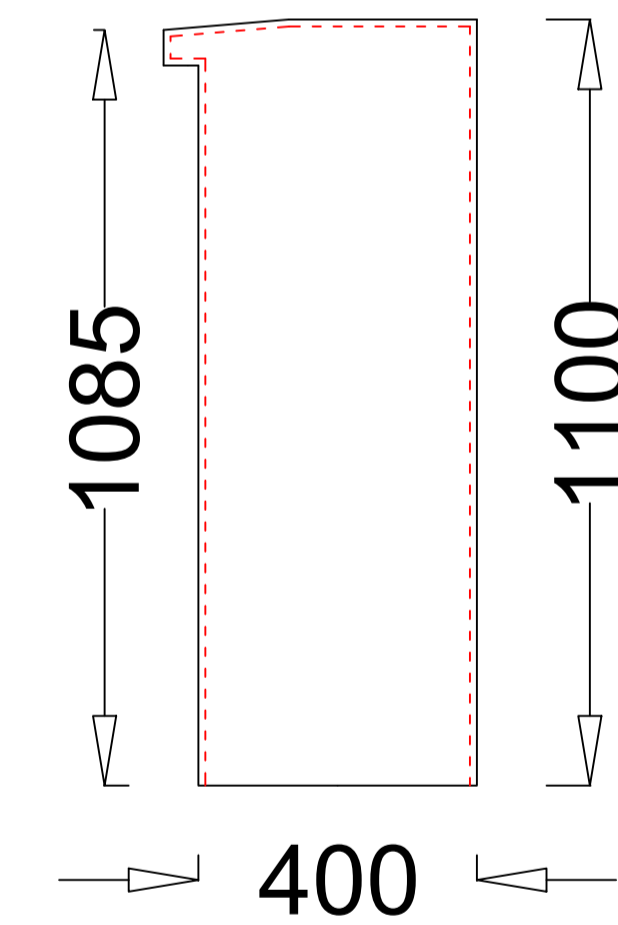
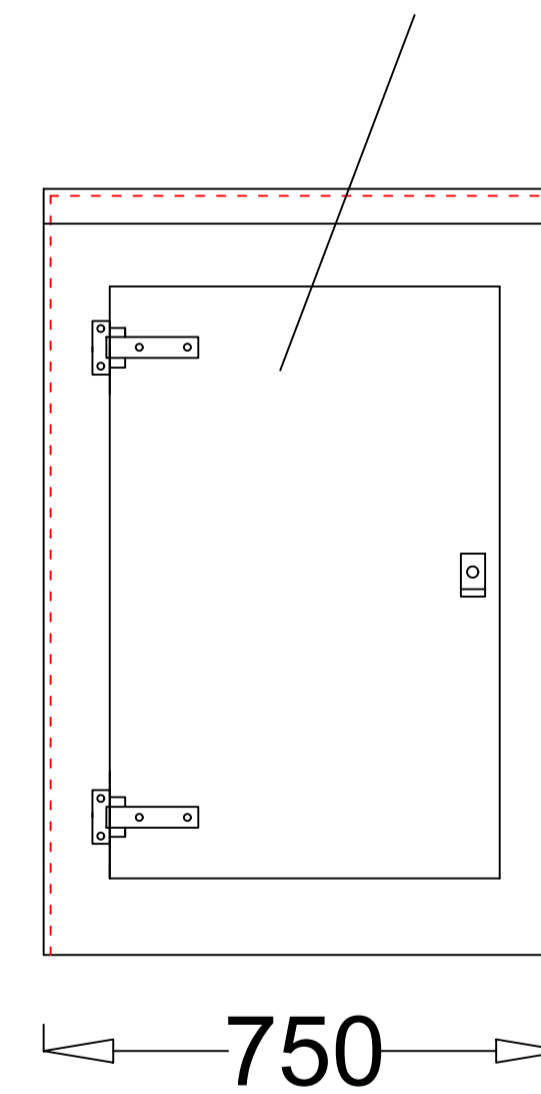
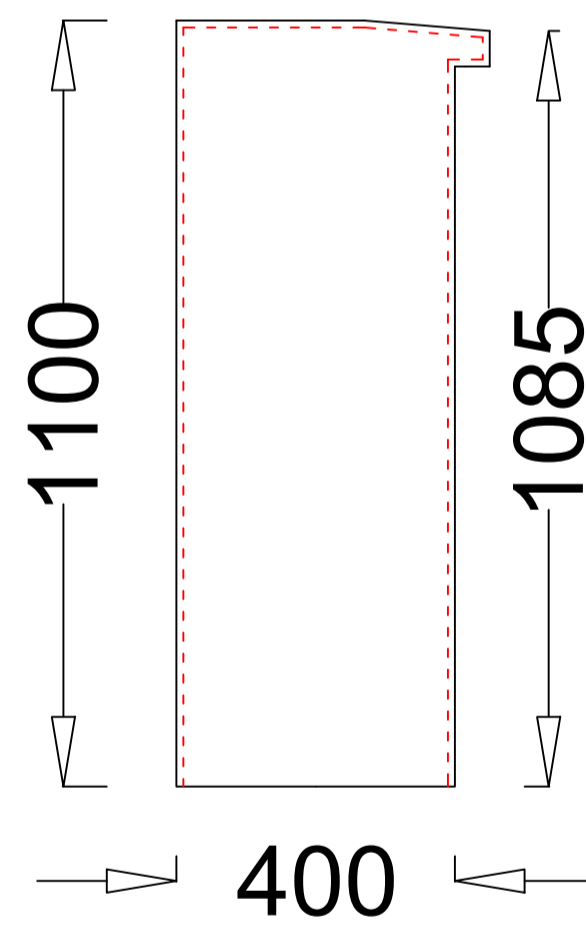

**GRP Enclosure**

+44(0)203 790 7877  
www.grpenclosure.com

**Company: GRP Enclosure**

Contact: +44(0)203 790 7877

**Scheme Title: VR4**

External Colour - BS or RAL

Approx. Weight = 30KG

"U" Value = 3.0 W/sq.m/degC

**Date: 22.05.23**

**Checked:**

**Construction: Single skin**

Drawing No. VR4

Job No. VR4

Rev: